

Council approves upgrades

By Danielle Benson
Brea Progress

In any type of big development project, unforeseen costs seem to always arise out of the blue. The \$10 million Brea Community Center is no exception.

At the Nov. 21 City Council meeting, councilmembers approved a \$40,000 upgrade for the center's proposed audio, visual and security systems.

"The change order focused on the facility's need for a sophisticated public address system," said Ret Wixted, community services director.

Wixted said the new system will allow paging in specific areas of the 51,000-square-foot building. Before the upgrade, a general system would have allowed for paging throughout the entire building, with a gymnasium-style echoing effect. It did not factor in different groups that may be in meetings in various areas of the building who wouldn't need to hear the announcement.

"This new system will meet the space needs of the building," Wixted said. "For example, the Community Room divides into one-third, two-thirds, and three-third sections. This system allows for private announcements in each section that won't be heard in the others. It is area specific."

The \$40,000 system upgrade came out of the project contingency fund, specifically set up for minor set-backs such as this. Wixted said the project manager believes the building will still come in under budget.

The new community center is scheduled to open the first week in June.

7-18-96

This is it, officials say

Community Center opens July 27

By Danielle Benson
Brea Progress

After more than 20 years and several recent delays, the Brea Community Center will open for sure July 27.

City officials cancelled the Center's Sneak Preview and Grand Openings on June 29 and July 6 because of construction delays such as light fixture installations and last minute aesthetic enhancements. Then pre-registered classes, which were supposed to start July 8 in the center, relocated for three weeks to a variety of "nooks and crannies" throughout the city.

Recreational activities such as art workshops, Mommy and Me dance classes and youth karate began in the Senior Center, Pioneer Hall and at several Brea school campuses. The classes move to their permanent homes in the center the week of July 29, center officials said.

"I think they projected that things would be done faster than they are getting done," Community Center Supervisor Deni Tidland said about the various delays. "It's just a very complicated building with lots of different materials. It's hard to switch gears quickly from say glass to concrete to wood flooring."

John Hogan, the project manager, added that the \$9.4 million project encompasses a wide scope of construction techniques which take time to complete. As the opening date neared, little loose ends remained dangling.

- ▶ Ballet and Tap
- ▶ Creative Dance
- ▶ Pre-Ballet
- ▶ Music
- ▶ Music and Motion
- ▶ Sunshine Generation
- ▶ Arts & Crafts
- ▶ Pre-school Picasso
- ▶ Mommy and Me Art Class
- ▶ Enrichment
- ▶ Teddy Bear Picnic

YOUTH

Sports

- ▶ Spirit Cheerleading Camp
- ▶ Girls' Academy
- ▶ Boys' Academy
- ▶ Tumbling
- ▶ Youth Karate (Beg./Int.)

Dance

- ▶ Ballet
- ▶ Jazz (Beg./Int.)
- ▶ Folk Dances from West Africa
- ▶ Hip Hop

Music

- ▶ Music Makers
- ▶ Sunshine Generation — performing group

Fine Arts

- ▶ Mixed Media
- ▶ Summer Sunflowers (beg.)

Arts & Crafts

- ▶ Polyform Clay
- ▶ Under the Sea — Shells
- ▶ Stenciling and Sponge Painting
- ▶ Basic Drawing
- ▶ Cartooning
- ▶ The Sunday Cartoonist
- ▶ Children's Art Books
- ▶ Incredibly Awesome Crafts for Kids
- ▶ Drawing and Making Dinosaurs
- ▶ Art of Comics
- ▶ Kids Craft Creations
- ▶ Once Upon a Recipe
- ▶ Multi-cultural Culinary Creations

Enrichment

- ▶ Fun-O-Friends (phonics)
- ▶ Fun-O-Grams (phonics)
- ▶ Sign Language for Kids
- ▶ Spanish for Kids
- ▶ Beginning Sewing for Children

BREA PROGRESS

A weekly newspaper with personality

PUBLISHED BY THE ORANGE COUNTY REGISTER ON THURSDAY NOVEMBER 21, 1996

Center complete within budget

But is it paying its own way?

By Danielle Benson
Brea Progress

More than 20 years of planning, **scrimping and saving** culminated in the completion and OK recently by the City Council of the \$9.6 million Community Center.

About \$187,000 in construction **change orders** has been approved since CAL-PAC Construction broke ground in January 1995. But the project, which included landscaping, construction, parking lot paving, furniture and supplies, came in on budget.

Now that the center is finished and in operation for three months, how is it doing?

"We've definitely met a need," Community Services Director Ret Wixted said, noting that more than 130 kids attend the afterschool programs. "From 2:30 to 3:00 they're coming from all directions."

More than 4,800 **people each week** use the community gathering place, which came under fire several times for construction delays, change orders and added expenses. This number includes drop-in workouts, tiny tots, afterschool participants and room-rental clients, Wixted said. She added that the rush of people is in response to the \$5 Community Center activity cards. Center staff expects numbers to balance out with steady program attendance.

The center, funded with redevelopment money, was approved in 1994 with the stipulation that it operate with a 70 percent cost recovery by the third year. The city will subsidize 50 percent this year and 40 percent next year. Wixted isn't worried.

"As of the third month (August-October), we're working at a 60 percent recovery," she said. "We have success indicators such as 20 new programs in which we balance the revenue sought with how many people we need. For example, the health and fitness component needs 148 people a day. By that (assessment), we're doing great."

Wixted said the afterschool program and the monthly teen Hot Friday Nights are the center's most successful events. Each day after school more than 100 kids swarm the teen zone, gymnasium and outdoor play areas.

"This was definitely a priority for us," Wixted said about youth programs. "Our Hot Friday Nights are packed. We want it to have a cool feel. Not a bunch of parents walking around, so we make it just for the kids."

Wixted said other programs, such as English as a Second Language classes, teen/parent groups and Super Saturday parent/child programs also are full.

"We're seeing a bunch of grandmothers and single dads coming with their kids on Saturdays," she said. "It gives them a little guidance and a sense of community spirit and that's what the center is all about."



PERSONAL TOUCH: Brea Olinda High School art students Becky Huffman (left) and Stephanie Sadell use shoes to add a personal touch to the Community Center sign.

COMMUNITY CENTER:

You can't lift it up and plop it down in any other city

sports facility in the city.

"The gym will be a godsend for what we want to do," he said. "But also look at the overall picture of what the Community Center offers. There's something for everybody in town."

He suggested that once the center was in operation, "we'll learn more about how to use it, and we'll find hidden advantages we didn't even know we'd get."

Design Committee member Bob Wettlin joined the center's Outreach Team in 1989 as an outgrowth of his stint on the planning commission. As the father of two daughters, he said he was well aware of the need for additional gym space in Brea. But he admitted his first

reaction to a Community Center was, "What do we need one of these for?"

"Working on the Design Committee has been a real growing experience for me," he said. "I found out a lot of community people wanted this. And there were so many factions that wanted so many different things. And we also wanted to look beyond to the future needs of Brea."

And what is he especially proud of?

"The whole thing," Wettlin said.

"With all the financial challenges, it's amazing that it's even there," he noted. "It was a struggle from start to finish — how to pay for it, how to fund it, how to make it work. And all done in fairly trying times, in the midst of the Orange County

bankruptcy."

And the work won't necessarily be over when the center opens. Wettlin is concerned about keeping the center funded on an annual basis and sees a need for volunteer help to make it work. Munro wants to find ways to avoid fees for youth groups and predicts a need for even more gym space. And Arriola is anxious to get immediate feedback from Brea teens.

"Any teen who has suggestions about programs or activities should call me at 990-7734," Arriola said. "It'll be neat to get their feedback, because what we think is cool might not be cool anymore."

Brea resident Gilbert Arriola remembers when he was a youngster and someone came to his home to talk about a proposed community center. Now age 21 and a senior at Cal Poly Pomona, Arriola is part of the team gearing up for this summer's grand opening of the Brea Community Center.

Arriola, who serves as youth and adult sports coordinator for the city, is working with Chris Emeterio, the city's athletics specialist, on programming for the center's sports, fitness and teen activities. As opening day approaches, they delve deeper and deeper into the intricacies of scheduling gymnasium hours, organizing teams for youngsters and adults, and setting up fitness classes for the healthy and the frail.

Arriola is especially excited about the Teen Center, a special area for Brea's youth to "hang out, have fun and plan for their own activities."

"We want the kids to make the decisions (on programming)," he said. "We want them to feel like its their center, not the city's center."

Arriola's emphasis on creating a center that reflects the interests of Brea residents is shared by the four members of the Community Center Design Committee who have worked for years to develop a center that is unique to Brea and, as their Mission Statement reads, is "open to all ages" and serves as a "focal point for the people of Brea ... to play, to learn, to socialize, to create, to seek help, to relax and to celebrate."

"The mission statement is the one thing that guided us all along, whenever there were decisions to make about how to use space or what programs to include," said design team member Claire Schlotterbeck,



whose personal dream of a park at the center fell by the wayside.

"The bottom line was, this was about a community center, not about open space," said Schlotterbeck, who has worked on the Community Center concept since she was a Parks and Recreation commissioner in 1985. "We tried to reach a balance in age groups and in activities. And, most of all, we wanted people to know there was a place to go to do things or to get information. If you're new in town, if you're lonely, if you need exercise, if you need a safe place for activities ... there's something for everybody, all year 'round, at the Community Center."

Some highlights of the Community Center's facilities and programs: a 5,800-square-foot Community Hall with catering kitchen and patio; meeting rooms for business seminars or group activities; an arts studio and art garden; an 11,236-square-foot gymnasium; a fitness area with an aerobic/dance studio, fitness training room and shower, and locker facilities; a Tiny Tots area with classroom, learning playground and picnic tables; a youth and family services area offering parenting, counseling and educational classes and information; and the teen center.

Special features include the dramatic Concourse that runs the length of the building and

the Center Cafe, offering snacks and light meals within view of gymnasium activities. And be on the lookout for a myriad of more personal "special touches" as well —

The athletic shoe impressions on the gym walls made by Brea residents; the gymnasium sound panels shaped and painted to represent Brea hillsides; the concrete walkway scored and cut to represent an oilrig; the Plaza Grove, and the orange tree in the Community Hall patio; the light columns covered with tiles personalized by Brea residents; and the entry wall impressed with the silhouettes of people appearing to walk into the center.

Even the temporary Community Center sign on Randolph Street has been personalized by Brea Olinda High School seniors Becky Huffman, youth liaison to the Cultural Arts Commission, and Stephanie Sadell, who copied their classmates' shoes to decorate the sign.

"What I like most about the Community Center is that it is so unique to Brea. You can't lift it up and plop it down in any other city," said Design Committee member Delaina Hofacre. "All of the leisure things that are so important to our community are in this building ... It's a blend of sports and cultural arts and children's activities and family services."

Fellow committee member Bob Munro, first president of the Brea Olinda High School Ladycat Booster Club and a Bobby Sox booster for 25 years, has worked on the Community Center concept since the early 1980s, when he was a Parks and Recreation commissioner. He said Brea was an especially sports-oriented town, and there was a real need for an indoor

Community Center deemed on target

By Jennifer D'Andrea
Brea Progress

After more than six months in business, the \$9.3 million Brea Community Center is being called a success by city officials, but the state-of-the-art building needs about \$45,000 worth of improvements, according to a committee that evaluated the center.

The four-person committee examined the Community Center's building, financial situation and programs, and on Tuesday made recommendations to the City Council on what to improve.

The recommended upgrades are for items in the center that need to be repaired or added, according to the committee.

The center costs \$835,884 per year to operate, and city officials projected a 50 percent recovery of that amount during the center's first year.

Sixty-eight percent of the cost

to operate the center during the first six months has been recovered, which means the city is ahead of schedule, said Assistant City Manager Tim O'Donnell. As a result, an extra 6 percent of the building's annual cost is expected to be recovered by June 30, the center's first birthday.

"The bottom line is this place has been a great success," O'Donnell said. "The community has helped us understand what's good and what's bad about the Community Center. The purpose of this meeting is to look at the things that aren't working."

The council agreed to increase gym fees by \$20 per hour for non-residents and an additional \$15 per hour for non-Brea based non-profit organizations.

The committee recommended discontinuing the center's after-school program during the sum-

Please see CENTER/2

CENTER

FROM 1

mer, although Councilwoman Lynn Daucher disagreed. Daucher suggested keeping the program, which is funded by donations, throughout the summer by paying for it with the extra 6 percent in operating costs that is projected to be recovered by June 30.

The following is a list of items that will be repaired or added and their estimated costs:

Repairs

- ▶ gym floor: \$3,580
- ▶ repaint patio furniture: less than \$1,000
- ▶ secure driveway bollards: \$5,000

Additions

- ▶ security system upgrades: \$19,500
- ▶ widen cafe counter: \$3,200
- ▶ change sign from "Community Center" to "Brea Community Center": \$1,900
- ▶ gym curtain modification: \$4,116
- ▶ fitness/gym entry point: no cost
- ▶ relocation of "The Brea Series" artwork: \$1,900
- ▶ install security fencing and safety wall behind gym: \$10,000

Thurs Sept 19, 1972



News Tribune Photo

OPEN HOUSE — City Councilman and Mrs. Tom Kowalski inspect light fixtures at newly-remodeled Brea Community Center building, 500 Sievers Ave., recently. About 50 persons accepted invitations to attend open house which marked first public view of \$2500 renovation including carpets, lowered ceiling, draperies, polished floor, decorative maps, light fixtures and wall surfacing.

THIS IS THE CURRENT
SENIOR CENTER

The Brea Community Center ...

Everything you'd expect and more ... much more

By Bev Perry
Brea City Councilmember
For the Brea Progress

"City Focus," a feature begun last month in this newspaper, provides City Councilmembers an op-

portunity to present news, views and other information on a monthly, rotating basis. **Bev Perry, a councilwoman not on the ballot in next week's election, offers this month's City Focus:**

The Brea Community Center ... what an incredible place! Chances are, you and your

CITY FOCUS

family have been there before ... for all kinds of reasons ... to celebrate special occasions, participate in special events like "Family Night," to take special-interest classes and learn new skills, to exercise or play basketball at the Fitness Complex, to hang out with

friends at the "Teen Zone," to drop your kids off at the After School Program where In-Line Hockey is the latest craze, or perhaps, just to enjoy a quick bite to eat or grab a cup of coffee at the Center Cafe.

But, the Community Center is bursting at the seams with many, many other free services, programs and activities for you and your family. Take the Youth and Family Resource Center, for example.

A registered nurse from St. Jude Medical Center is on-site once a month to answer medical questions and provide referrals (private, 15-minute in-person or telephone appointments are available). A variety of free classes taught by health care professionals are also offered each month.

Upcoming topics include, "Healthy Thanksgiving Cooking" and "Un-Stressing the Holidays." I think I'll sign up for both of these! There's even a Tutoring for Teens program where students can get individualized help with homework.

You've probably already checked out the Center's Fitness Complex, but did you know it offers a really cool custom-

ized workout service? That's right, for a nominal fee, a member of the Fitness staff will design a customized workout program just for you. So, don't let those new-fangled fitness machines intimidate you.

If you're interested in getting back into shape, you're in luck! Trained staff are always on hand to help you get started.

Got kids? Then KidWatch is for you. It's an affordable baby-sitting service that offers a flexible child care solution while you're at the center or other city facilities. KidWatch is also available to guests attending functions in the center's meeting rooms and banquet hall.

These are just a few highlights of the many services that await you at your Community Center. I encourage you to take a moment to drop in and really explore what the center has to offer.

You'll be glad you did. And, a word about the staff and volunteers. I challenge you to find a more dedicated, highly energetic, friendly and enthusiastic group of people under one roof.

My hat's off to these folks who make the Community Center such a dynamic place.

To keep up to date on upcoming Community Center programs and activities, visit our website at www.ci.brea.ca.us or call (714) 990-7100.



PERRY

City Council votes 4-1 ^{Feb 23 95} to go ahead with center

By Aaron Boehme
Brea Progress

The time is right, the need is there and the money is available.

That's the conclusion the Brea City Council came to Feb. 16 when members voted 4-1 to move ahead with construction on the \$6.2 million community center residents started asking for 17 years ago.

"This was not the council's idea — this was the community's dream," Councilman Burnie Dunlap said.

Construction on the center, near the corner of Randolph Avenue and Birch Street, was put on hold in December because of budget problems related to the Orange County bankruptcy.

Redevelopment money intended to fund the center was frozen in the bankrupt investment pool, and when city officials began to search for other funding sources they also found other funding problems, Mayor Bev Perry said.

Because of the recession, the tax value of the city didn't grow at the anticipated rate, and escrow bonds taken out in 1991 to fund the center can't be released from the bank until the city reaches a certain projected value, explained Finance Director Larry Hurst.

But the interest earned on the bonds is allowing them to pay for themselves until they can be released, probably in about three

Hurst said.

Meanwhile, city officials have decided to use the lease on the Brea Civic and Cultural Center as collateral so they can borrow more money to fund the center, Hurst said.

The Redevelopment Agency will make the payments on the new loan, he said.

The other option was to wait until the escrow bonds were available, but that would end up costing the city more in the long run, he said.

Delaying the project for three years would force the city to breach its contract with the builder and incur significant legal costs, officials said.

Waiting would also force the city to have the center redesigned so that it conformed to three years of new building regulations, they said.

And the city would lose \$134,000 in grants.

Despite the assurances of city staff that the redevelopment agency had the revenues to pay off the new bonds, Councilwoman Kathy Wisner voted against going ahead with construction, saying she heard similar assurances before the county bankruptcy.

"I was always under the impression that the money was there, but then we had the bankruptcy and we found out that it wasn't," Wisner said.

"The numbers at the end seem to work out now, but they worked out before and that makes me skeptical," she said.

8-1-96

Councilmembers,

Wiser, Mayor
Burnie Dunlap and
Councilman Glenn
Parker cut the rib-
bon to celebrate
the grand opening
of the Community
Center on Satur-
day. Members of
the community
turned out
en masse to tour
the high-tech
building.

Stan Bird/
Brea Progress



A must-use situation

BREA COMMUNITY CENTER



Open to all ages throughout the year, the Community Center will be a focal point for the people of Brea... A place to:

- *Play*
- *Learn*
- *Socialize*
- *Create*
- *Seek Help*
- *Relax*
- *Celebrate*

FLOOR PLAN

ACTIVE ZONE

- | | | | |
|----|--------------------|----|------------------------|
| 1 | Entry Concourse | 15 | Workroom |
| 2 | Reception Counter | 16 | Conference |
| 3 | Administration | 17 | Office |
| 4 | Vending | 18 | Teen Patio |
| 5 | Arts & Crafts Room | 19 | Teen/Lounge/Music Room |
| 6 | Kitchen | 20 | Babysitting |
| 7 | Community Lockers | 21 | Tiny Tots Classroom |
| 8 | Storage | 22 | Sport Concourse |
| 9 | Electrical | 23 | Aerobic & Dance Studio |
| 10 | Mechanical | 24 | Fitness Room |
| 11 | Community Hall | 25 | Gymnasium |
| 12 | Community Patio | 26 | Women's Locker Room |
| 13 | Classroom | 27 | Men's Locker Room |
| 14 | Reception | 28 | Juice Bar |



FAMILY ZONE

RESIDENT/COMMERCIAL ZONE

SITE PLAN

BREA COMMUNITY CENTER
CITY OF BREA
CALIFORNIA



THE COLLABORATIVE TEAM
WEBER AND ASSOCIATES
PICKARD PARTNER

PREPARED BY
WEBER AND ASSOCIATES
12115 FORTY-FIFTH STREET
SUITE 102
CULVER CITY
CALIFORNIA

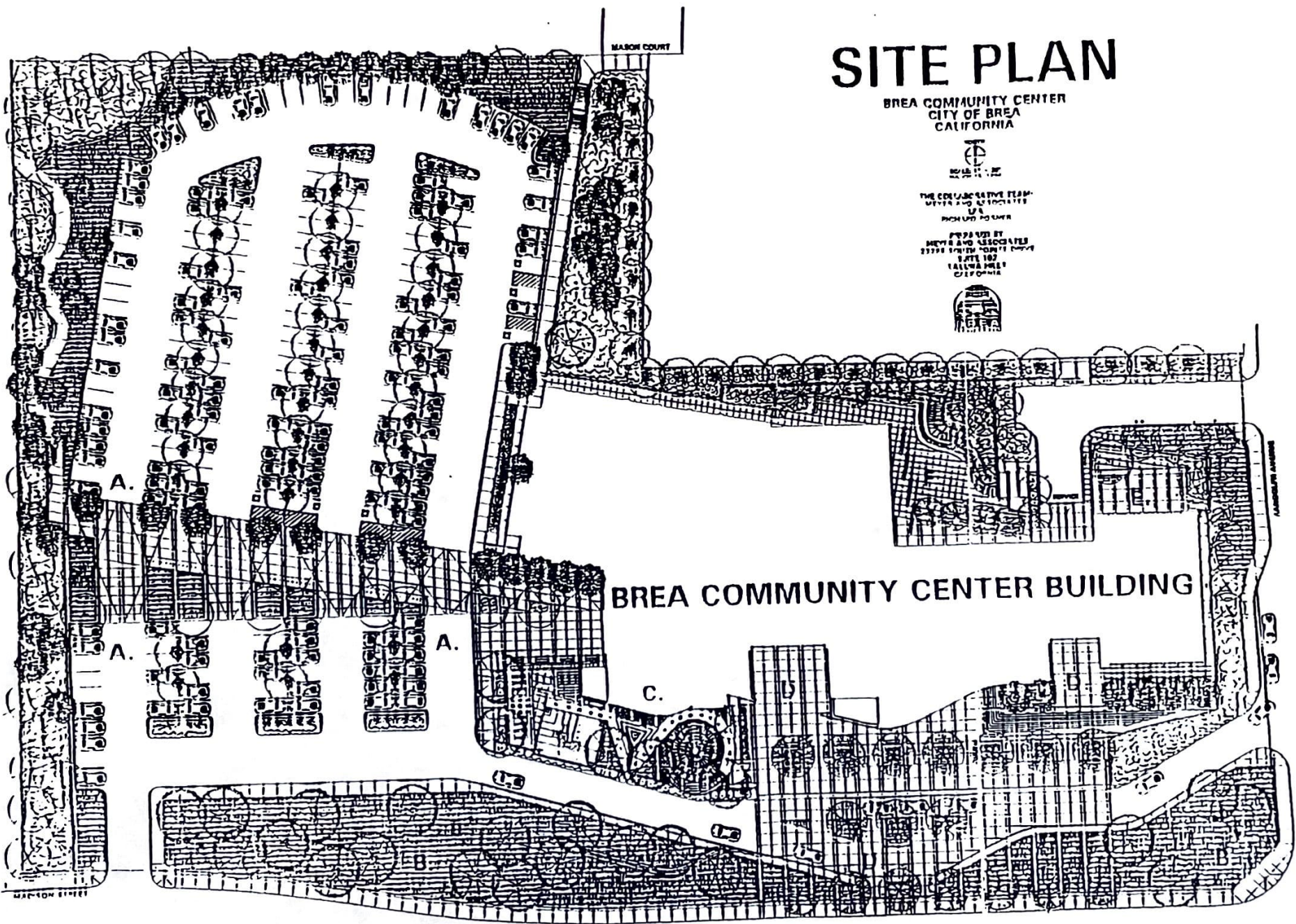

BREA COMMUNITY CENTER BUILDING

A. Entry Plaza - West
D. Entry Plaza - South

B. Madison Street Frontage
E. Hall Patio

C. Tot Patio
F. Arts Patio

The Brea Community Center...

Be a part of it!

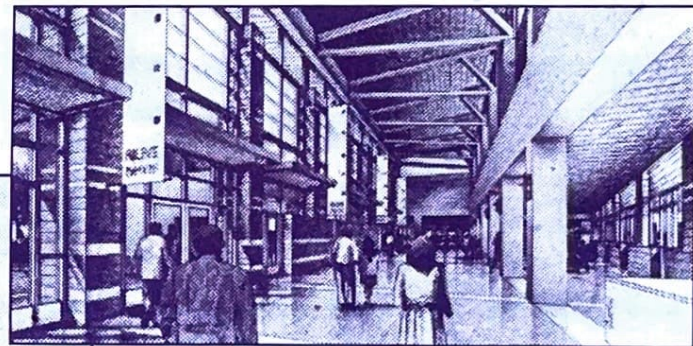
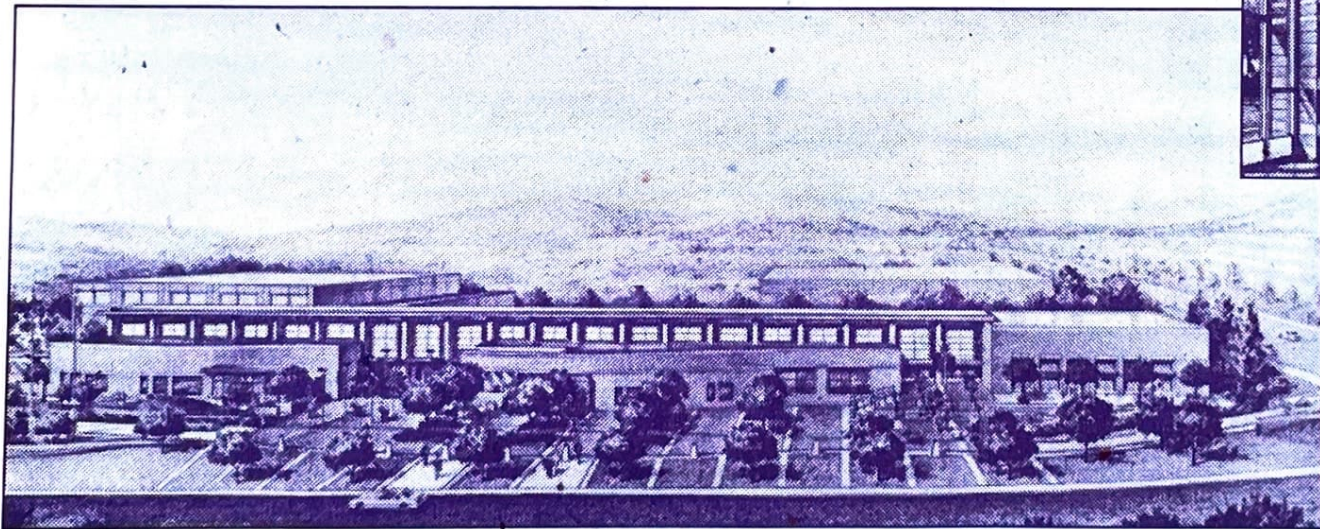

The countdown to a "grand" opening in 1996 is on...

CITY OF BREA COMMUNITY CENTER

◆◆◆ History in the Making ◆◆◆

The people of Brea have long held a dream for a place where the community can come gather, to play, to learn, to socialize, to seek help, counselling and guidance, to celebrate and recreate.

As early as 1976...

the Parks, Recreation and Human Services Commission recognized this desire and included it in the City's Parks and Recreation Master Plan. When this plan was updated in 1986, one of the major goals was to design and build a Community Center.

In 1988...

the City Council appointed a Citizens' Task Force to explore the feasibility of building a Community Center. This committee studied numerous sites, the potential impact on traffic and neighborhoods, community needs and estimated costs to build such a facility. Later, this Task Force grew into a Community Center Committee made up of an Outreach Team and a Design Team. This committee conducted an extensive written survey which identified components to be included in the design.

The need for a Community Center was also addressed by the Brea Project, a dynamic citizen-based long-range planning group. A survey conducted by this group confirmed community support for the construction of a Community Center.

In 1990...

a Design Team was formed by the City Council to develop the program and design the facility. This team included professionals, citizens from the community a building architect and a landscape architect. The Team visited over 20 community centers in Southern California to aid them in creating a state-of-the-art facility to meet the ever growing and changing needs of the community.

In August of 1993...

the City Council approved the construction of a 51,000 square foot facility created and designed by the community for maximum flexibility and multiple use.

February, 1995...

Marked the start of construction for the Community Center which is scheduled to open in the Summer of 1996.

Watch for it!

CITY OF BREA COMMUNITY CENTER

Coming in 1996, the City of Brea Community Center is designed to become a focal point for Brea; a place where all are invited to come together to play, learn, socialize, create, seek help, relax and celebrate. The Community Center will be a place to meet the community's ever growing and changing needs for cultural and recreational activities and human services.

This beautiful, state of the art facility will be open and accessible to all ages and interests. Throughout the year the Center will be open from 6 a.m. - 10 p.m. Monday through Friday, from 10 a.m. - 8 p.m. on Saturday and 10 a.m. - 5 p.m. on Sundays. Additionally, the Center will be open for special events and can be rented for weddings, banquets, receptions, etc.

Programs and Facilities

Active Recreation (Sports) Facilities - 11,236 square feet



The gymnasium will accommodate a variety of sports activities including basketball, volleyball, indoor hockey, soccer, dances, contests, special theme parties. The Fitness Area will feature strength training and cardiovascular fitness, instruction programs and exercise and dance classes for all ages.

- ◆ Gymnasium
- ◆ Volleyball courts
- ◆ Aerobic exercise and dance studio featuring a cushioned hardwood floor
- ◆ Full court basketball with spectator seating for 300+
- ◆ Fitness and weight training center
- ◆ Men's and women's shower & locker facilities

Community Center Café

A great place to gather with friends. A delicious assortment of health conscious foods and beverages are served.

Family and Youth Services



A very strong commitment to youth and families is evident at the Community Center. A free, supervised afterschool program will be offered at the Center every weekday. Kids can come with their friends and play games, get help with homework and make craft projects. Also there will be programs to promote healthy families such as parenting workshops, tutoring and referrals to specialized services.

- ◆ Tiny tots classes
- ◆ Baby sitting services
- ◆ Teen lounge
- ◆ Childrens' learning playground
- ◆ Youth and family services
- ◆ Youth employment service

Special Use and Community Rental Facilities



A variety of rooms have been designed to accommodate a wide range of activities from Community events to classes ranging from arts and crafts to karate and computer seminars and rental by businesses and individuals. Rooms open onto an outdoor patio.

- ◆ Grand Community Hall with outdoor patio
 - Banquet seating for 390
 - Auditorium style seating for 600
- ◆ Catering kitchen
- ◆ Art garden
- ◆ Meeting rooms
 - Classroom-style seating for 30,
 - Auditorium style seating for 50
- ◆ Art studio, classroom style seating for 32

For more information about the Community Center, call 990-7771

CITY OF BREA COMMUNITY CENTER

◆◆◆ Programs ◆◆◆

When you come through the doors of the Brea Community Center, we want you to know you're just the person we want to see! Inside you'll find a facility designed for use by all. Here is a place you can come to relax, work-out, learn a new skill, attend business meetings, personal seminars, family celebrations or enjoy special community events with your neighbors and friends. You can also experience the "arts," attend workshops, seek help for yourself or a loved one, watch your children learn new skills and play competitive sports. This is a place for you!

Our goal is to make it easy for you to enjoy your Community Center. Need a babysitter for your kids? No problem, bring them along. While you're working out, attending a workshop or visiting with friends at the Café, they can stay and play in our state-of-the-art child care and babysitting area. Your kids will love coming to the Community Center too! They can learn to shoot hoops, create works of art in a craft class, dance like a ballerina or fine-tune their karate moves. There'll even be a special free "Kids Count Club" every weekday after-school to give kids a place to get help with homework, socialize with friends and play games in a safe, supervised environment.

The Door's Always Open (well, almost)

For your convenience, the Community Center will be open weekdays from 6 a.m. - 10 p.m., Saturdays from 10 a.m. - 8 p.m. and on Sundays from 10 a.m. - 5 p.m. And that's not all, the Center will be open additional hours for community-wide special events and for private rentals by individuals, businesses and organizations.

Toddlers - Youth Programs & Activities

- ✿ Tiny Tots facility & learning playground
- ✿ Babysitting service for parents using the Community Center facilities (ages 2 & older)
- ✿ Sports programs like baseball, volleyball, basketball, roller hockey and soccer
- ✿ Brea "Kids Count Club" afterschool program for youth.
- ✿ Educational tutoring
- ✿ Special interest classes

Teen Programs & Activities

- ✿ Teen Lounge complete with pool table, ping pong table and music listening room
- ✿ Special interest classes
- ✿ Arts and crafts classes
- ✿ Sports leagues, tournaments, clinics
- ✿ Youth and family services:

Adult Programs and Activities

- ✿ Sports leagues & tournaments
- ✿ Weight training facilities and classes
- ✿ Specialized fitness training programs
- ✿ Special interest classes
- ✿ Self-improvement programs
- ✿ Men's & Women's shower and locker facilities
- ✿ Arts & crafts classes
- ✿ Cultural arts programs

Other Services

- ✿ Centre Café: Great selection of nutritious snacks and meals
- ✿ Youth and family services like counseling, parenting classes, information & referral
- ✿ Banquet, conference and meeting facilities for rental
- ✿ Fitness & aerobic center

CITY OF BREA COMMUNITY CENTER

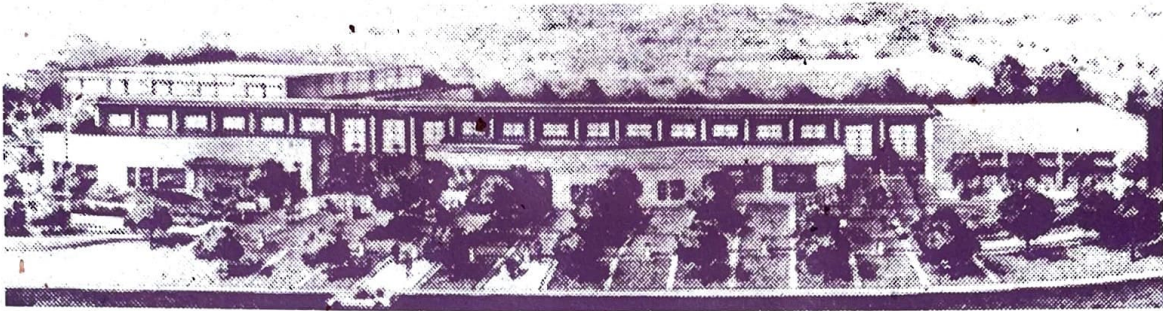

The Brea Community Center is funded by the City of Brea and the Brea Redevelopment Agency.

The budget for this public project budget is: \$9,400,000

Project components:

Design	\$1,116,000.
Construction Building	6,668,000.
Site development.	
Contingency	486,000.
Construction Administration	500,000.
Furnitures and Fixtures	600,000.

- Community Center land is owned "free and clear." Property was purchased by the Brea Redevelopment Agency
- General tax revenues will not be used for construction of the facility
- Continuing budget reviews and cost control strategies will ensure the Community Center stays within budget during construction.
- Project benefits all ages and interests groups within Brea.

CITY OF BREA COMMUNITY CENTER

◆◆◆ Community Profile ◆◆◆

Brea's The Place To Live, Play and Work...

Located in the northeast corner of Orange County, Brea is a family-oriented community of 34,500 residents. Blue-ribbon schools, strong youth and community programs, excellent public safety services and the flavor of small-town living combine to make Brea an outstanding place to live for residents of all ages.

Total Population: 34,000

• Male...49.7% • Female...50.3%

Population By Age

0-5 Years Old ... 7.9%

6-17 Years Old ... 15.3%

18-24 Years Old ... 10.9%

25-34 Years Old ... 18.7%

35-44 Years Old ... 17.2%

45-54 Years Old ... 12%

55-64 Years Old ... 8.7%

65-74 Years Old ... 5.9%

75-84 Years Old ... 2.7%

85+ Years Old ... 0.7%

Housing Values:

Ranges: ... \$170,000-\$500,000

Rents: ... \$400-\$1,000+/Mo.

Median: ...\$264,000

Median Rent: ...\$700/Mo.

Distinctive neighborhoods abound through-out the city, from charming bungalows built in the 1920's to brand new tract homes. Condominiums, apartment complexes and gated communities are also sprinkled throughout the community. A number of apartment complexes cater exclusively to Senior Citizens. Brea takes great pride in it's commitment to ensuring quality housing opportunities for all. Affordable, median and upper income housing is available.

Ethnic Groups

White ... 77.1%

Asian ... 6.00%

Black ... 01.0%

Indian ... 0.30%

Hispanic ... 15.40%

Other ... 0.10%

Brea is an attractive, well-maintained and aesthetically pleasing city. The city became one of the first in the county to implement trash recycling when it adopted an automated curbside collection system for recyclables in 1989. A tough anti-graffiti ordinance and a Graffiti Hotline have kept Brea free from this problem that plagues many other cities.

Outstanding Educational Opportunities...

School Age Population: 8,975

• Pre-Primary School ... 760 • Elementary/High School Students ... 5,147 • College Students ... 3,068

Brea's public schools consistently score at the highest levels in state and national achievement tests. A new high school opened in 1990 and features state of the art technology, a professional performing arts center and complete athletic facilities. Brea Olinda High School is also well-known as the home of the Ladycats, the 1992, 1993 & 1994 National Championship girls basketball team. Brea is also home to a number of outstanding private schools.

Brea's The Place To Work...

Over 60,000 people a day work in Brea. In addition to being a major retail center, Brea is home to many large corporations, such as UNOCAL, American Suzuki, Lucas-Western Aerospace, Beckman Instruments and Bank of America.

Daytime Working Population

65,000

Daytime Total Population

100,000

Business and Industrial Make-Up (Approximate)

Retail/Service Business ... 50% • Manufacturing/Industry ... 25% • Professional ... 12.5%

Real Estate/Finance/Banking ... 12.5%

BREA Community CENTER

◆◆◆ Floor Plan ◆◆◆

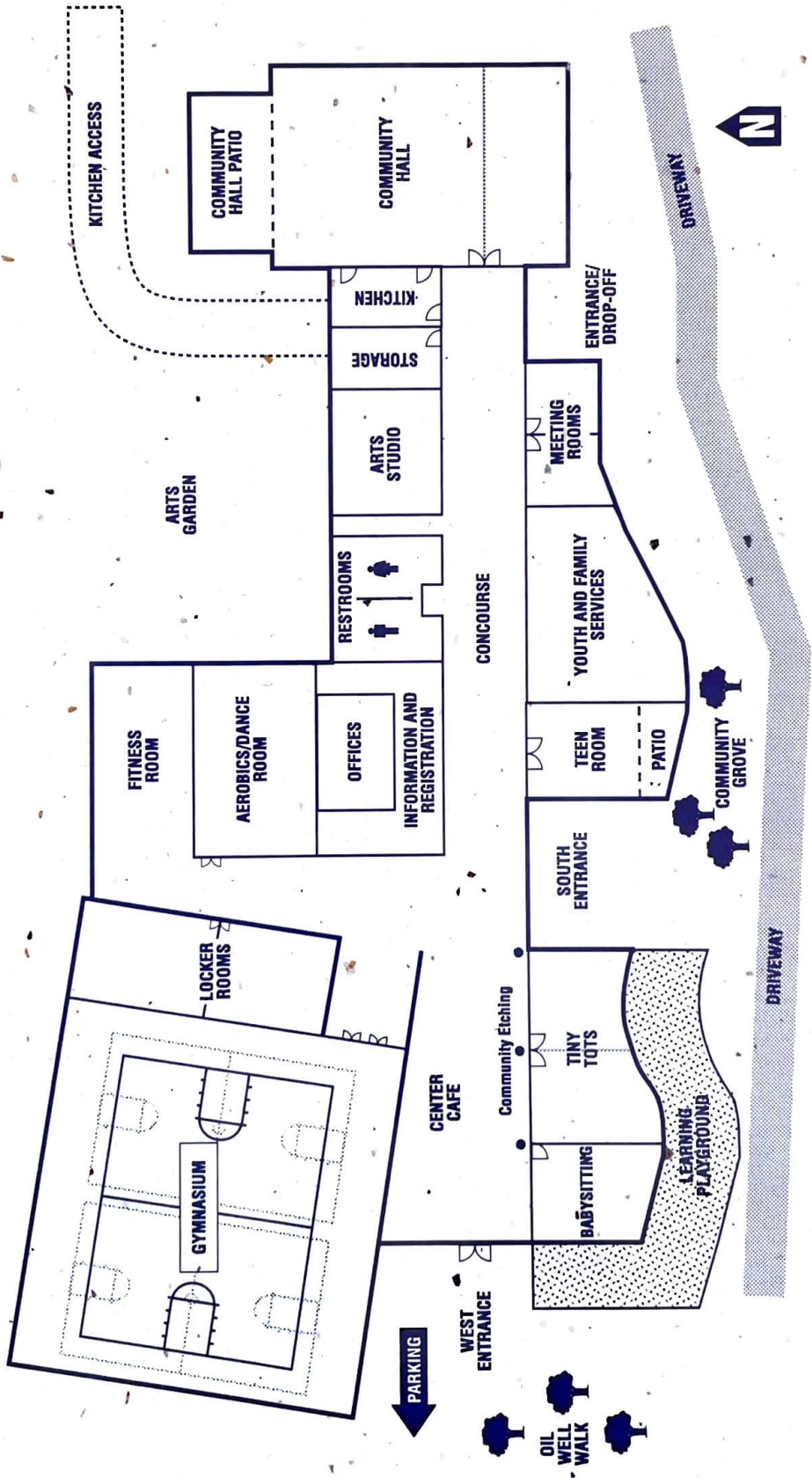

Brea Community Center

BREA *Community* CENTER

◆◆◆ Project Budget ◆◆◆

The Brea Community Center was funded by the
City of Brea and the Brea Redevelopment Agency .

The budget for this public project was: \$9,350,000

Project components:

Design	\$1,100,000.
Construction	7,100,000.
Building	
Site development	
Construction Administration	550,000.
Furniture and Fixtures	600,000.

- ◆ No general tax revenues were used for construction of the facility.
- ◆ Continuous budget reviews and cost control strategies ensured the Community Center was completed under budget.

Cities Inject a Little Personality Into Community Centers

By STEVE CARNEY
SPECIAL TO THE TIMES

Community centers are often the most public of a city's public buildings.

They house the pools where toddlers learn to swim, the gyms where teens gather after school to shoot hoops and where senior citizens cut a rug at dances, the classrooms where adults meet for night classes.

In recognition of that, many cities across Orange County have built their neighborhood centers with touches reflecting the soul of the community. They are trying to move away from simply erecting bland, utilitarian slabs of concrete.

"The new trend is to fit municipal buildings—particularly recreational facilities—into the environment and architectural designs of the local area," said Ron Hagan, Huntington Beach's director of community services.

In Brea, for example, city officials sought public comment at several community meetings as they planned a \$10-million center. It opened 10 months ago with a nascent orange grove in front, a nod to the area's citrus-growing history, and with exterior light fixtures shaped like oil derricks, reflecting another major economic influence. The soundproof panels inside the basketball court are designed to look like the hills surrounding Brea.

"We have a lot of little touches that make it less industrial, less governmental than some centers," said Ret Wixted, the city's community services director. "There's a connection with the past."

Those efforts contributed to widespread community enthusiasm about the new center.

"When it was ready, everybody was pretty excited about it," resi-

dent Gail Sheppard said as she waited at the facility last week with her husband, Dan, as their 5-year-old daughter, Jessica, frolicked with playmates after a class.

"Practically the whole city came out when it opened. The people who live here are very proud of this," she said.

Nikki MacNish, 14, said she often plays basketball and other games with friends at the Brea center.

"It's a good environment for kids any age to come to. It's safe," she said as she bandaged a blister one afternoon last week.

She and her friends prefer it to the Boys and Girls Club, which they used to attend, because "it's more interesting. There are more people our age," she said.

San Juan Capistrano will also look to its history when it builds its center this fall on land that was once the first walnut orchard in Orange County.

The city bought the 60-acre farm of local pioneer Joel Congdon and will build a \$5.6-million center there with architectural touches designed to mesh with the city's historic buildings, said Sharon Heider, the city's open-space project manager. Community meetings revealed that was what residents wanted.

"Since the money is coming directly from the community, there's obviously a need to be responsive to the community," Heider said.

Anaheim's older Brookhurst Community Center was built decades ago in the more customary style. But the city's new center, with its groundbreaking planned for June 3, will mirror the Craftsman-style buildings downtown, said Richard Bruckner, the city's redevelopment manager.

The city spent time on the design, he said, "to make sure it

had an inviting feel, a place where everyone in town could call home and feel comfortable."

Not all cities need to build anew to have centers that capture the spirit of the community. Huntington Beach decided to refurbish its community center, built in 1932 by laborers from the New Deal's Works Progress Administration.

"We thought it was important to maintain the uniqueness of the building," Hagan said. Though fixing the old building will cost about the same as building a new one, Hagan said, comments he has heard run 100 to 1 in favor of keeping the old gym.

"It will still look like an old-fashioned, institutional-type building. But I think there's something to be said for that era," Hagan said.

"I think people will find the historical aspect of it very exciting to see," he said, with the restoration of old-style water fountains, archways, transoms over doorways and louvers in the roof. "We'll give it its historical grandeur, if you will."

Any community center, whether new or old, gives each city an opportunity to trigger cultural awareness in its residents, said Dan Heinfeld, president of LPA Inc., the Irvine architectural firm that designed the Brea, Anaheim and San Juan Capistrano centers.

"It is a very, very public facility. That's one of the reasons we feel it ought to reflect the community, and their values and cultures," he said. "I think everybody has some pride in where they live."

While some people might dismiss Orange County as a homogeneous suburban sprawl, he said, there "really is a pretty rich and diverse history in the county, if you care to look for it."



By DAVID FITZGERALD / Los Angeles Times

"We have a lot of little touches that make it less industrial, less governmental than some centers," a Brea official said of the community center.

LA Times - 5-27-97
66-60-97

BREA Community CENTER

◆◆◆ Programs ◆◆◆

When you come through the doors of the Brea Community Center, we want you to know you're just the person we want to see! Inside you'll find a facility designed for use by all. Here is a place you can come to relax, work-out, learn a new skill, attend business meetings, and seminars, celebrate, or enjoy special community events with your neighbors and friends. You can also experience the arts, attend workshops, seek help for yourself or a loved one, watch your children learn new skills and play competitive sports. This is the place for you!

Our goal is to make it easy for you to enjoy your Community Center. Need a babysitter for your kids? No problem; bring them along. While you're working out, attending a workshop, or visiting with friends at the Café, they can play in KidWatch, our state-of-the-art child care and babysitting area. Your kids will love coming to the Community Center too! They can learn to shoot hoops, create works of art in a craft class, dance like a ballerina or fine-tune their karate moves. There is even a free After School Program every weekday to give kids a place to get help with homework, socialize with friends and play games in a safe, supervised environment.

The Door's Always Open (well, almost)

For your convenience, the Community Center is open Monday through Friday from 6 a.m.-10 p.m.; Saturdays from 8 a.m.-8 p.m.; and Sundays from 10

a.m.-6 p.m. And that's not all. The Center is open additional hours for special events and for private rentals by businesses, organizations and individuals.

Toddlers - Youth Programs & Activities

- ◆ KidWatch, babysitting service
- ◆ Tiny Tots classes
- ◆ Sports programs like youth baseball, basketball and mini-soccer, volleyball, and indoor soccer
- ◆ Free After School Program and Homework Club
- ◆ Special classes like Music & Motion, Pre-School Picasso, and Bugs & Buddies
- ◆ Parents' Night Out, the second Friday of every month
- ◆ Super Saturdays



Teen Programs & Activities

- ◆ The Teen Zone has ping-pong and foosball tables, a computer and a sound system
- ◆ Youth Employment Service
- ◆ Theme dances and concerts
- ◆ Fine arts, crafts, dance and fitness classes
- ◆ Sports leagues, tournaments, clinics and roller hockey
- ◆ Karaoke
- ◆ Excursions

Adults Programs & Activities

- ◆ Drop-in gym (includes basketball, volleyball and mini-soccer)
- ◆ Sports leagues and tournaments
- ◆ A variety of aerobics classes ongoing throughout the day
- ◆ Customized fitness training and wellness programs
- ◆ Classes for every interest including cooking, Tai Chi, Polynesian dance, bridge, fine arts, crafts and foreign language classes
- ◆ Cultural arts celebrations



Youth & Family Services

- ◆ Parenting classes
- ◆ Information/referral
- ◆ Scholarships
- ◆ Crisis intervention
- ◆ Tutoring
- ◆ Counseling
- ◆ Volunteer programs for teens.

Business Services

- ◆ Facilities available for meetings, training seminars, conferences, trade shows, receptions and parties
- ◆ Fitness and wellness programs for employees
- ◆ Noontime "QuikFit" programs

Other Services

- ◆ Center Café with a great selection of nutritious snacks and light meals
- ◆ Banquet, wedding, birthday party, conference and meeting facilities for rent
- ◆ Babysitting service for parents using the Center's facilities (ages 2 & older)





Brea Community Center

Grand Opening - Saturday, July 27, 1996

Celebrate the Day Away!

**The Brea City Council
Invites You To**

**See It...
Feel It...
Use It!**

**BREA
COMMUNITY CENTER
Opening Summer '96!**

**Brea Community Center
Opening Celebration**

Saturday, July 27, 1996

Ribbon Cutting & Open House

1p.m. - 4p.m.

**Demonstrations, activities and
fun for the entire family**

**Country Western BBQ
& Family Hoedown**

6p.m. - 9p.m.

**Music & family fun
(BBQ sponsored by the Brea Lions Club)**

**695 Madison Way
(Corner of Randolph Avenue
& Madison Way)**

**To purchase dinner tickets or for more
information call 990-7735**



City of Brea
Civic & Cultural Center
1 Civic Center Circle
Brea, CA 92821

Eric Nicoll
Number One Civic Center Circle
Brea, CA 92621

BREA Community CENTER

The Brea Community Center was designed with you in mind! Meticulously planned to include the features today's families want and need. Read on and discover some of the ways your neighborhood community center can fit into your day.

Operating Hours: Mon. - Fri. 6 a.m. - 10 p.m.; Sat. 8 a.m. - 8 p.m.; Sun. 10 a.m. - 6 p.m.

Gymnasium

Two full-sized basketball courts; multi-sport use; air conditioned; hardwood floors; bleacher seating

- Drop-in/challenge basketball
- Volleyball and mini-court soccer
- Adult leagues



Fitness Complex

Flexible payment options - frequent user passes; 10-visit punch card; daily usage fee, senior and youth discounts

Weight Room

Mirrored wall; televisions; locker room and showers

- Treadmills, bicycles, Stairmasters
- Pec Deck machine, Triceps Extension



Aerobics/Dance Studio

Mirrored walls; raised teaching platform; cushioned, hardwood floors; adjustable ballet barre

- "Step 2 It" step aerobics
- Senior Stretch-n-Strength
- Line Dancing, Karate, Tai Chi

Teen Zone

Stereo system; wide screen TV; Sony PlayStation

- Foosball, Ping-pong, video game tournaments
- Programs designed by and for young adults



Children's Activity Rooms

Colorful and safe surroundings; professional staff; learning playground

- Super Saturdays-special family events
- Tiny Tots, KidWatch baby-sitting service
- Free Afterschool Program



Youth & Family Services

Caring; confidential; no charge for services with exception of sliding scale counseling fee

- Youth Employment Services (Y.E.S.)
- Straight Talk counseling, life skill classes
- Information and referral, scholarships

Art Studio

Professional art tables and easels; demonstration table; natural lighting; inspirational art garden

- Mural painting
- Watercolor, cartooning, sculpture classes



Facility Rentals

More than 42,000 sq. ft. of rental space; efficient service; affordable prices; audio visual equipment available

- Grand Community Hall
- Training and meeting rooms
- Outdoor patio and garden



Bistro 695

In-house cafe; dine-in or take out; variety of healthy menus

Specialty coffees, Italian ices, frozen yogurt

Catering services available

Brea Community Center

695 N. Madison - (Randolph & Madison)

(714) 990-7100

Photos by La Neve Photographics

BREA *Community* CENTER

◆◆◆ Facilities ◆◆◆

This 51,000 square foot, state-of-the-art facility is accessible to all ages and interest groups, as well as to the business community. The Center is open Monday through Friday from 6 a.m.-10 p.m.; Saturdays from 8 a.m.-8 p.m.; and Sundays from 10 a.m.-6 p.m. The Center, located at Madison Way and Randolph Avenue, is open for special events and is the perfect place for weddings, banquets, receptions, and private meetings. An expansive plaza provides space for outdoor events, while a 300 foot long concourse connects a multitude of programs all under one roof. The concourse's glass wall, transparent by day and lantern-like by night, provides a warm invitation to the neighborhood. A pedestrian drop-off area and ample free parking add to the building's convenience.

Grand Community Hall

This elegant 5,000 square foot reception space features a hardwood floor, coffered ceilings with lighting and an enclosed patio with trellis covering, making it the ultimate location for banquets, parties, celebrations, class reunions, weddings and receptions.

- ◆ May be divided for smaller receptions or meetings
- ◆ Private 2,650 square foot landscaped patio
- ◆ Catering kitchen with loading area accommodates basic to elegant food service
- ◆ Tables, chairs, portable bar and portable stage available
- ◆ Banquet-style seating for 320 or theatre-style seating for 650

Meeting Rooms

Two rooms, each 500 square feet, are perfect for business meetings, seminars, training classes and breakout spaces for large seminars held in the Grand Community Hall.



- ◆ Accommodates up to 40 people theatre style; or 25-30 classroom seating
- ◆ Wall-mounted marker/boards
- ◆ A/V equipment available
- ◆ Windows overlooking plaza

Arts Studio and Art Garden

The 1,530 square foot studio opens onto a private 6,600 square foot landscaped Art Garden, ideal for outdoor weddings, receptions or private parties.



- ◆ Ceiling to floor windows overlooking Art Garden
- ◆ Demo table with mirror
- ◆ Classroom-style seating for 32
- ◆ Art Garden occupancy 210
- ◆ Children's activity area accommodates up to 16'
- ◆ Easels, floor lamps and storage available

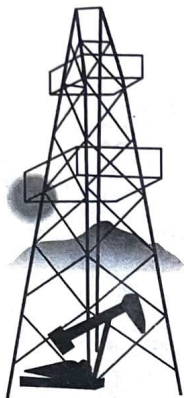

Inside

Automotion C1
 Classifieds A23
 Brewing A6
 Neighbors A7
 Northern Lights A15
 Real Estate B1
 Sports A14

"Theatre of Light and Motion"

4 The variety of light at the Brea Gallery's new exhibit is likely to open some eyes and leave flash spots.

With six different gasses, various types of stained glass tub-

ing or tubing coated inside with phosphorescent paint, an artist can create more than 120 different colors. With such variety, it's no surprise each of the show's 19 artists expresses light so wildly.

Hoops revival

14 Gene Lloyd's Rose Drive Friends Basketball Camp reaches beyond youth basketball into the high school game. Lloyd, who un-retired from coaching at Brea Olinda High, learned this first hand when the faces on the court became increasingly familiar.

BREA PROGRESS

An Orange County Register publication

THURSDAY, AUGUST 17, 1995

Another brick in the wall?

Community Center already swamped with reservations

By Aaron Boehme
 Brea Progress

The walls are barely up, but requests to use the Brea Community Center are pouring in.

Construction crews planted the first 20-ton cement wall on Aug. 8, in what will eventually become the gym. Although the building's completion is months away, recreation supervisor Chris Emeterio is already scheduling its use.

"We'll never have any problems filling the gym," Emeterio said. "I can see teen leagues going on Friday at 11 at night, indoor soccer... That thing is just going to be swamped."

Brea has never had a gym, and most cities do, he said as reason for the facility's popularity. And the gym at Brea Olinda High School is booked up, he added.

The problem, he said, is to balance all of the groups that want to use it. The Community Services Department is already working on a solution.

The Community Center is supposed to be self-supporting, so there have to be groups paying rental fees, Emeterio said.

"But at the same time, we're trying to provide free after-school programs," he said. "We're trying to work out a balance."

Time is on Emeterio's side, however. Construction probably won't be finished until mid-April, said Ron Kishpaugh, project manager for the city.

"A lot of it depends on the weather," he said. "And even when that's finished, there's still chairs to move in, carpets, all the stuff you still have to do before the people come in."

City officials tentatively scheduled the grand opening of the center for summer, 1996. Delays plagued the project, however.

First, the Orange County

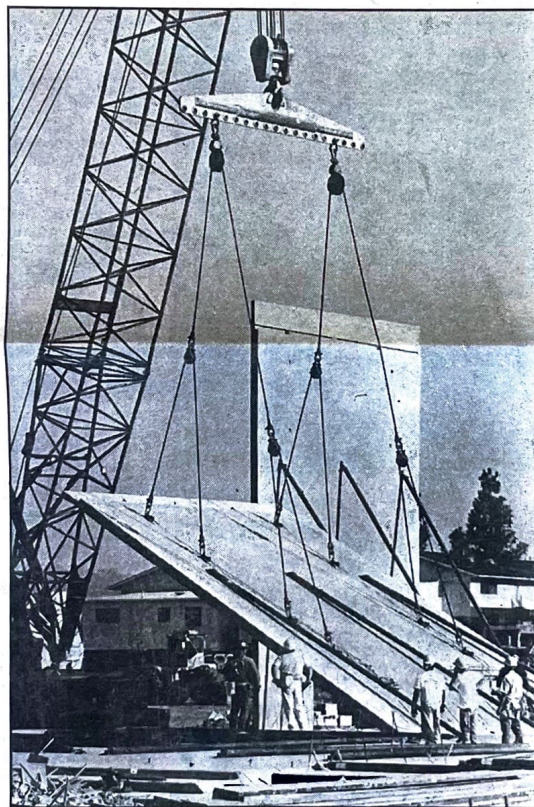

Stan Bird/Brea Progress

Construction workers raise the first walls last week for the new Brea Community Center. The 20 tilt-up panels weigh as much as 40 tons.

bankruptcy, then weather, then it was found that various groups had used the property as a dumping ground for dirt that had to be cleared away before construction could begin.

Nevertheless, community services personnel have already started raising money to fund the after-school programs and help the center maintain self-sufficiency.

Various contribution programs earned \$14,550 as of Aug. 10. But, according to communi-

ty service estimates, at least \$23,000 is needed to run the after-school programs each year.

Donors who contribute \$2,500 or more will have one of 22 Gallery Pear Trees planted in their honor in the Plaza Grove.

And \$100 donors will own one of the 180 hand-etched glass panes decorating the west main entry.

Smaller donations also are welcome.

To donate call 990-7771.



AARON BOEHME

... On the road again

By Aaron Boehme
 Brea Progress

Editor's note: Aaron Boehme turned in his reporter's notebook on Aug. 11, so he could pursue a teaching credential at California State University, Fullerton. The staff at the Brea Progress wishes him good luck. Aaron's last assignment was to check out the traffic problems in Carbon Canyon.

It must be Murphy's Law or at least a corollary of it.

If you expect an easy road, it won't be. If you prepare for a troubled path, it'll be smooth sailing.

I expected leaving Brea and a journalism career to be easy. I was tired of the job and enthusiastic about returning to school to become a teacher.

I expected cruising out of Brea via the Carbon Canyon Road evening rush to be a supreme challenge. Area residents say its bumper-to-bumper all the way.

I was wrong on both counts. With a Super Big Gulp full of Cherry Coke and a bag of gummy bears, I was ready to tackle whatever traffic Carbon Canyon threw at me.

I tried at 5:15 p.m. Tuesday.
 I tried at 5:45 p.m. Wednesday.
 For good measure, I tried again at 4:30 p.m. Thursday.

All three times I breezed from the 57 freeway to Chino Hills and back in 25 minutes or less.

The only bumper-to-bumper traffic I saw

Please see REPORTER/2

MILESTONES

MARRIAGE LICENSES

- ▶ **Rastavan**, Hamid Reza, 33, auto mechanic, Brea and **Pittser**, Kathy Diane Rastavan, 33, homemaker, Brea. Filed: July 6.
- ▶ **Caraballo**, Cesar Gustavo, 43, driver, drapery installations, Brea and **Marin-Romero**, Martha, 34, repacker, pharmacy warehouse, Brea. Filed: July 7.
- ▶ **Fredenberg**, Glen Mark, 31, audit mgr., public accounting, Brea and **Ogrodski**, Denise Lauren, 28, sr. accountant, public acctg., Anaheim. Filed: July 10.
- ▶ **Catalano**, Frank Anthony, 24, mechanic, oil drilling tools, Anaheim Hills and **Kracik**, Jennifer Lynn, 22, college student, child development, Brea. Filed: July 17.
- ▶ **Sandoval**, Rojelio Arturo, 24, restaur-

- ant cook, Paramount and **Avilla**, Rosaemma, 20, inspector, aircraft parts, Brea. Filed: July 21.
- ▶ **Samuels**, Arthus Norman, 61, owner, spec. adv., Running Springs, CA. and **Brooks**, Merrilyn Lee Spicer, 55, recruiter, search firm, Brea. Filed: July 24.
- ▶ **Trefry**, Albert Allen, 92, blacksmith, Brea and **Strong**, Luella S. Collins, 96, homemaker, Brea. Filed: July 26.
- ▶ **Karagines Jr.**, Peter, 46, owner/operator, food distributor, Brea and **Schester**, Linda Rose, 31, ofc. mgr., food distribution, Brea. Filed: May 23.
- ▶ **Froning**, Douglas Paul, 24, civil engineer, Newport Beach and **Hurst**, Jennifer Anne, 23, college student, accounting, Brea. Filed: June 7.
- ▶ **Velasco**, Ruben, 30, construction

- worker, Brea and **Thacker**, Colleen Carisa, 24, social worker, emergency youth shelter, Brea. Filed: June 23.
- ▶ **Francois**, Kevin Lee, 29, salesperson, furniture, Brea and **Hegg**, Michelle Marie, 29, ofc. mgr., commercial painting, Diamond Bar. Filed: June 23.
- ▶ **Lemay**, Laurance Marshall, 45, ceo/pres, real estate, Brea and **Manson**, Genevieve Colleen Easton, 45, educator, Brea. Filed: July 3.
- ▶ **Eisenpeter**, Jeffrey Richard, 34, general contractor, cabinetry, Brea and **Gibbs**, Helena Rozanna, 25, chiropractic student, Downey. Filed: July 5.
- ▶ **Phillips**, Bruce William, 45, account exec., insurance, Diamond Bar and **Dickens**, Martha Ann, instructor, education, 47. Filed: July 11.
- ▶ **Blackney**, David Russell, 33, teacher, Brea and **Ford**, Anne Elizabeth, 33, registered nurse. Filed: July 17.

Santa Fe offers compromise on Olinda Heights

By Aaron Boehme
Brea Progress

Santa Fe Energy, Inc. is once again reducing densities and altering development plans for the 284-acre Olinda Heights property at the corner of Carbon Canyon Road and Valencia Avenue.

Residents have opposed vehemently the density of Sante Fe's development since the planning stage started about four years ago.

The company originally proposed more than 2,000 residences. But after years of local opposition the number has dwindled to 847.

Opponents, however, said the quantity should be reduced further to 497 units, the number city officials estimated the property can accommodate based on the city's General Plan.

But city staff members said the general plan never was intended as an exact guide, so the planning commission recommended approval of the 847-unit proposal.

Nevertheless, local opposition has increased since the City Council began reviewing the project in July. In response, Santa Fe officials decided to reduce densities once again at Tuesday's council meeting.

The new proposal, tentatively scheduled for a special council meeting Aug. 22, will decrease the density by about 10 percent, said John McLaughlin, spokesman for Santa Fe.

It will definitely not be down to the 497 unit level, he warned, arguing that even if Santa Fe stuck

to the general plan, it could build about 600 units because some of the units are designated affordable, and the general plan allows for a 20 percent density increase with affordable housing.

McLaughlin said he wasn't sure of the exact density reduction because the decision just occurred, and project designers have to examine street layouts and infrastructure to determine necessary changes.

They also will be looking at changes to make the homes more earthquake resistant, and possibly installing methane gas barriers beneath all structures rather than just on a case-by-case basis, he said.

Despite these changes, however, McLaughlin predicted the project's opponents would still complain.

"We just hope that some of the people who have really looked at the project would see it as something that meets with their plan and the housing they would like to see," he said.

During the public comment period of the council meeting, some residents said any development would destroy the rural nature of the canyon, while most others said they would accept the project at the 497-unit level.

Residents raised concerns such as traffic, air pollution, noise and several health and public safety hazards related to the oil production at the site and the nearby county landfill.

The City Council will query city consultants about these issues at a special meeting at 6 p.m. Aug. 22.

Reporter

FROM 1

was turning right onto Carbon Canyon Road from Valencia Avenue — the intersection targeted for improvement if the Olinda Heights project is approved.

It was a little slow once when I got stuck behind an old, blue gardening truck maxed out at 20 mph laboring up a hill. With an extra lane at the beginning (another improvement planned with the development), I could easily have passed the jalopy.

I'm not saying there's never traffic in Carbon Canyon. I've been told cars flow better through the canyon in the Summer, but tend to trudge along when the 91 (Riverside) Freeway slows down.

And occasionally I've seen Lambert Road back up from the Carbon Canyon/Valencia intersection all the way to Kraemer.

Even on my test trips there was no shortage of cars, but, for the most part, everyone exceeded the speed limit.

Maybe I just got lucky, or unlucky, since I didn't get to finish

my gummi bears. Either way, driving out of Brea was a snap.

On the other hand, turning in my two weeks notice and saying goodbye to the School Board members and City Council members after spending all those late nights meeting with them for the last 8 months — now that was not so easy.

Cleaning two years of newspaper clippings and fast food napkins out of my desk also proved a challenge.

But the hardest reality comes in not meeting all of the people who will now make news in the community. The up-and-coming artists at the Brea Gallery, the outstanding or outspoken students at Brea Olinda High School, and the 30-year retirees moving on to better things, they'll tell their stories to someone else.

Who knows, maybe I'll be back someday.

Meanwhile, if anyone would like several dozen packets of ketchup, mustard or hot sauce, they're in my desk.

COUPON

RECYCLE FOR BACK TO SCHOOL CASH

We Honor Most Competitors' Coupons!

OPEN: M-F 8 to 4:30 pm • SAT 8-2 pm

C O U P O N

- NEWSPAPER \$ 110.⁰⁰ ton
 - ALUMINUM CANS \$ 1.¹⁵ lb.
 - GLASS (CRV) 5 ½' lb.
 - PLASTIC (CRV) 50¢ lb.
 - CARDBOARD \$ 110.⁰⁰ ton
- (Fullerton location only)



John's Recycling Center

714/525-4567
1250 E. Walnut
Fullerton

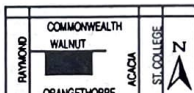

310/697-1845
571 S. Harbor Blvd.
La Habra 90631

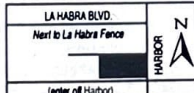

COUPON

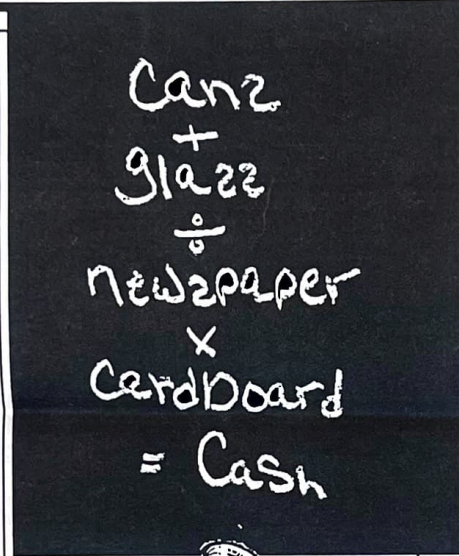



Deals ON WHEELS

'87-'88 JAMBOREE RALLY



28,500 miles.
\$13,000 obo

(714) **538-0964**

'92 DODGE RAM VAN



2500 Custom, 318 mag eng., auto w/OD, AC, PS, PB, PL, 4 cpt. chairs, elec. couch/bed.
27K **\$17,500 obo**

(714) **772-9506**

'74 JAGUAR XJ-12L



New paint, int. & P235R tires. Series III mag wheels, V12. Low mi. Tinted windows. **\$10,000**

(714) **744-1489**

HOME IMPROVEMENT & SERVICE DIRECTORY

<p>ADDITION/REMODELS</p> <p>IN 'A DAY CONSTRUCTION</p> <ul style="list-style-type: none"> * ROOM ADDITIONS * KITCHEN & BATHS * BAY, BOWS & CIRCULAR WINDOWS * DOOR REPLACE INT./EXT. * ELECTRICAL <p>FREE EST. LIC#B1612010 (714) 871-2319</p>	<p>AIR CONDITIONING</p> <p>D-BROS HEATING & A/C</p> <p>WE WILL BEAT ANY LEGITIMATE WRITTEN EST.</p> <ul style="list-style-type: none"> * QUALITY WORK * REFERENCES INSURED • BONDED <p>(714) 776-8925 LIC #670567</p>	<p>ELECTRICAL</p> <p>Accurate Connection Electrical</p> <ul style="list-style-type: none"> • LOWEST RATES • FOR HIGHEST QUALITY LIC. # 670104 <p>FREE ESTIMATES (714) 778-5758 or 1-800-225-0256 PAGER ID # 895950</p>	<p>HANDYMAN</p> <p>CALDERWOOD HOME REPAIR</p> <p>HANDYMAN SERVICE SINCE 1988 SR. Discount Available Business Licensed LENNY (800) 9-LENNYS VOICE MAIL 502-6666</p>	<p>PAINTING</p> <p>PAINT 911</p> <ul style="list-style-type: none"> * EXTERIOR * * SPECIALIST * • Extensive Preparation • Stucco Repair Experts • Quality Materials • Meticulous Results • FREE Color Coordinating <p>Licensed & Bonded LIC. #886753</p> <p>FREE ESTIMATES Cal Chip's Painting References (310) 493-0105</p>	<p>PLUMBING</p> <p>** DISCOUNT **</p> <ul style="list-style-type: none"> * Plumbing * Heating * Air Conditioning <p>All repairs, makes & models No job too small. <i>(FAST) Discount to All!</i> No extra charge for Sunday & Holidays. <i>Call Anytime!</i> Lic / Bonded / Insured (714) 537-1122 I'll beat anybody's pricell</p>	<p>POWER WASHING</p> <ul style="list-style-type: none"> • Ext. Home & Bus. • All Types Of Siding • Restored Decks, Sidewalks, & Driveways • Free Estimates Taking Appts. For Sept. <p>Craig Danzig (714) 579-1480</p>	<p>SCREENS</p> <p>20 % Off All Windows 10 % Off All Doors FREE ESTIMATE 24 HR. SERVICE CUSTOM FITTED ALSO</p> <p>Specializing in Security screen doors ABC SCREENS (714) 871-2464</p>
<p>ADDITIONS/REMODEL</p> <p>ALL PRO BUILDERS</p> <ul style="list-style-type: none"> * ROOM ADDITIONS * REMODELING * KITCHEN & BATH <p>FAMILY OWNED & OPERATED FREE ESTIMATES (714) 255-0131 LIC. #570520</p>	<p>ALL HOME REPAIRS</p> <ul style="list-style-type: none"> ■ Alteration ■ Wood Framing ■ Masonry ■ Insurance Repairs <p>30 Yrs. Exp. Dependable, Semi-Retired Contractor (714) 750-4629 (714) 826-6171 SL LIC#516317</p>	<p>GARAGE DOORS</p> <p>STEEL DOORS AS LOW AS \$800 INSTALLED!</p> <p>GARAGE DOOR OPENERS</p> <p>ELECTRICAL INSTALLATION AVAIL. WINDOW DESIGNS AVAILABLE LIC # 682062 (800) 208-0729</p>	<p>HOME SAFETY</p> <p>HELPING HAND GRAB-BARS, ETC.</p> <ul style="list-style-type: none"> • Bathroom Grab-Bars • Handrails • Anti-Slip Floor • Tub Treatment <p>TOP QUALITY PROFESSIONAL INSTALLATION (310) 694-6730</p>	<p>PATIO</p> <ul style="list-style-type: none"> * WOOD LATTICE PATIO COVERS * DOOR HANGING * GATES & FENCES * CONCRETE * FOOTING & SLABS * HOME REPAIR! <p>FREE EST. PROVIDENT BUILDERS (714) 774-3396 or V.M. (714) 324-5162 LIC # 380798</p>	<p>POOL CARE</p> <p>WATER KLEEN</p> <ul style="list-style-type: none"> • Monthly Service • Acid Washes & Repairs • Special Offer For New Customers <p>(714) 636-SWIM</p>	<p>ROOFING</p> <p>WILBER ROOFING INC.</p> <p>SINCE 1975 ALL TYPES OF ROOFING Commercial Residential * FULLY INSURED * * FREE ESTIMATE * (714) 827-0861 LIC #322179 C-39 WORKER COMP/LIABILITY INS.</p>	<p>SPRINKLER SYSTEMS</p>  <p>(7 1 4) 704-3750</p>
<p>ADDITION/REMODELING</p> <p>THURBER CONSTRUCTION</p> <p>Lic #395641, 20 yrs. Exp. Honest-Reliable-Refs. Room Additions 2ND Stories-Kitchens-Bath Rooms. Custom Building. Free Interior Design * Free RT FOR 2 TO L.V.N.V. With Any Addition & Still Save \$\$\$. FREE EST. (714) 229-8212</p>	<p>CABINETS</p> <ul style="list-style-type: none"> ◆ REFINISHING ◆ REFACING ◆ NEW KITCHEN CABINETS ◆ ALL DESIGN/CUSTOM CABINETS ◆ LOCAL REFERENCES <p>FREE EST. 14 YEARS IN BUSINESS NO JOB TOO SMALL PETER (714) 842-5463 PAGER 568-7423</p>	<p>HANDYMAN</p> <ul style="list-style-type: none"> * GENERAL HOME MAINTENANCE * CARPENTRY * CUSTOM FURNITURE * PAINTING * BATH * KITCHEN & FLOORS * WINDOWS & DOORS <p>SR. DISCOUNT Business Lic. FREE EST. VICENTE G. REYES (714) 522-0620</p>	<p>MASONRY</p> <p>DISCOUNT MASONRY</p> <ul style="list-style-type: none"> ■ Block Walls ■ Stone & Cement Driveways/Patio <p>(714) 827-2902 Bonded & Lic #708767</p>	<p>HOUSE PAINTING</p> <p>BLACK AND WHITE PLUMBING & REMODELING</p> <ul style="list-style-type: none"> • Plumbing • Kitchen & Bath • Remodel • No Hassle • Feel Good <p>VISA/MC 800-547-6392 St. Lic#359300B-C-336</p>	<p>POOL SERVICE</p> <p>COWBUNGA POOLS</p> <ul style="list-style-type: none"> * Maintenance * Chemicals * Repairs * Acid Washes * One Time Cleans <p>Call Dave For free Estimates (714) 956-5844</p>	<p>ROOFING</p> <p>GALLA-RINI CONSTRUCTION</p> <p>ROOFING</p> <ul style="list-style-type: none"> • ALL ROOFING NEEDS • PATIO COVERS • SKYLIGHTS • FENCES <p>Bonded & Insured License #663983 FREE ESTIMATES (714) 974-6424</p>	<p>STATELY PALMS</p> <p>BEAUTIFY YOUR HOME</p> <p>We Stock</p> <ul style="list-style-type: none"> • Queens • Kings • Sagos <p>Interior Etc. Specializing in Artistic Tree Pruning Pool Landscaping Tree Trimming Firewood (714) 529-2047</p>
<p>ADDITIONS/REMODEL</p> <p>REMODELING ROOM ADDITIONS CUSTOM HOMES</p> <ul style="list-style-type: none"> ** We offer ** Creative Design Ideas Affordable Quality Superior Craftsmanship <p>Inc'd., Lic# 497155 Call for free consultation (310) 697-7768 SPOTHELPER CONST.</p>	<p>ADDITION/REMODEL</p> <p>DISCOUNT CONSTRUCTION</p> <ul style="list-style-type: none"> * ROOM ADDITION * KITCHEN/BATHS * WINDOW/DOORS * ROOFING * PATIO COVERS * PLUMBING <p>LIC #708767 FREE EST. (714) 827-2902</p>	<p>HANDYMAN</p> <p>VERY VERSATILE</p> <p>Extensive paint prep Carpentry-plumbing Ceramic Tile, Linoleum Wood fences & Gates Tub Surrounds & Enclosures Complete Bath & Kitchen Remodel, Doors & Lock sets CALL DAN (714) 256-4337</p>	<p>INTERIORS PAINTED</p> <p>Under \$75 per room Includes Paint</p> <ul style="list-style-type: none"> * Wallpaper Expert * Carpet Cleaning <p>EXT-SINGLE STORY From \$795 Free Power Wash (714) 870-0885</p>	<p>PLUMBING</p> <p>BLACK AND WHITE PLUMBING & REMODELING</p> <ul style="list-style-type: none"> • Plumbing • Kitchen & Bath • Remodel • No Hassle • Feel Good <p>VISA/MC 800-547-6392 St. Lic#359300B-C-336</p>	<p>POOL SERVICE</p> <p>COWBUNGA POOLS</p> <ul style="list-style-type: none"> * Maintenance * Chemicals * Repairs * Acid Washes * One Time Cleans <p>Call Dave For free Estimates (714) 956-5844</p>	<p>ROOFING</p> <p>GALLA-RINI CONSTRUCTION</p> <p>ROOFING</p> <ul style="list-style-type: none"> • ALL ROOFING NEEDS • PATIO COVERS • SKYLIGHTS • FENCES <p>Bonded & Insured License #663983 FREE ESTIMATES (714) 974-6424</p>	<p>IMAGEMAKER VIDEO</p> <p>PROFESSIONAL VIDEO SERVICES</p> <ul style="list-style-type: none"> • Weddings • Business • Parties <p>In Studio Editing Up to 3 Cameras Make a Video Photo Album Picture & 8mm Transfers (714) 996-4881</p>

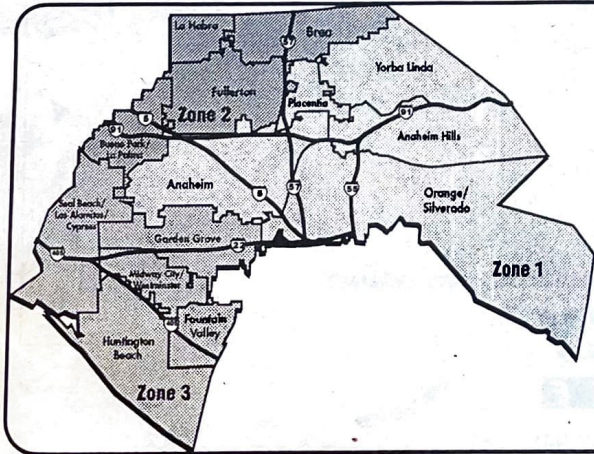

- Zone 1 - Anaheim, Anaheim Hills, Placentia, Orange, Yorba Linda**
- Zone 2 - Brea, Buena Park/La Palma, Fullerton, La Habra**
- Zone 3 - Fountain Valley, Garden Grove, Huntington Beach, Midway City/ Westminster, Seal Beach/Los Alamitos/Cypress**

TO ADVERTISE IN THESE AREAS
CALL 704-3750
COMMUNITY CLASSIFIED

Pitter-Patter, Your Feet Matter.

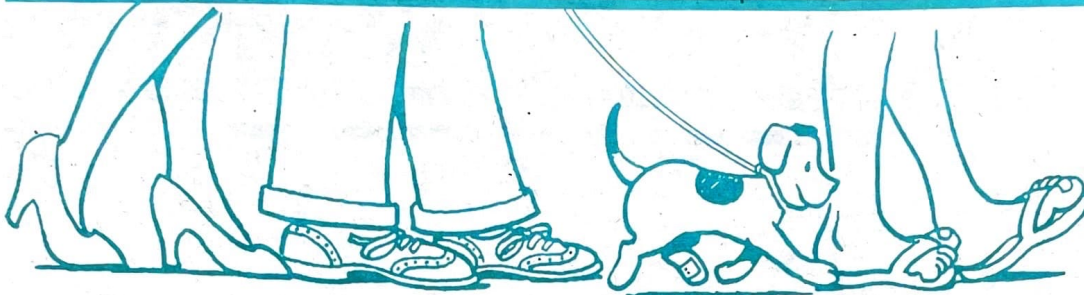

The Podiatry Institute at Whittier Hospital Medical Center
is offering a

FREE SCREENING CLINIC

The Podiatry Clinic
is Now Open On Wed. & Thurs. From 2:00 P.M. to 5:00 P.M. ONLY
For appointments please Call (310) 907-1733
Don't Hesitate Any Longer, **CALL NOW!!!**

FREE Foot Exam



PODIATRY
INSTITUTE

15151 Janine Drive, Whittier, CA (310) 945-3561

BE A PART OF IT... The Brea Community Center!

Designed by the community, this beautiful 54,000 square foot facility is guaranteed to be unlike any other community center in Southern California. From the community-inspired design, to the amenities, to the programs and services, the Brea Community Center will be truly unique and will fulfill a dream long-envisioned by people of all ages.

As the Community Center takes shape, community excitement will grow with each milestone passed...Don't just sit back and watch, show your support and help make it happen!

To make it easy for everyone "to be a part of it," we've designed a Community Center Contribution Program to meet just about every interest and pocketbook. Personalize a hand-etched glass pane which will be part of an original work of art adorning the west entryway. Consider purchasing a Gallery Pear tree to decorate the south entrance, or buy a Liquid Ambar tree to be planted along the Center's Oil Well Walk.

Perhaps you'd rather make a contribution to support the Brea Kids Count Club, a free after-school program, or the Helping Hands Scholarship Program. Or maybe you'd rather volunteer at the Center. Whatever your interest, we need you to "be a part of it."

Long-awaited, the Brea Community Center will soon become a reality. Opening in 1996, the Community Center will serve as a focal point for the people of Brea to come together to play, learn, socialize, create, seek help, relax and celebrate.

Through a myriad of programs, activities and services, the Community Center will reflect the ever-growing and changing interests of Breans of all ages. You can be a part of it now!

Plaza Grove

Twenty-two Gallery Pear trees will create a welcoming invitation to Community Center visitors. This grove of beautiful trees will adorn the main entrance of the south plaza. Donor names will be inscribed on a black granite plaque at the base of each tree. Additionally, donors will receive a certificate suitable for framing and will be invited to the Community Center Grand Opening. This is the perfect way for a business or organization to make a lasting contribution to the community. Minimum donation is \$2,500.

Oil Well Walk

Be a part of the "Oil Walk," one of the focal points of the Community Center. Purchase one of eleven Liquid Ambar trees that will border a walkway designed to represent an early 20th century Brea oil derrick. Your name will be engraved on a permanent granite marker located in front of the tree. Minimum donation is \$500.

Community Etchings

One of the Community Center's most intriguing features is an original glass art sculpture by Washington artist, Ro Percer. Three pillars, consisting of 180, 6" x 6" engraved glass panes, create ever-changing patterns of light inside the west entrance.



Leave a lasting remembrance or message by purchasing and personalizing one of these panes. You can personalize etchings for yourself, your friends, or your family (memorialize a loved one, write an inspiring message for all to read, say thanks to a friend, tell someone you love them). The possibilities are endless! Each glass pane is constructed by hand out of brilliant "post consumer, recycled" green glass using a 1906 glass press. Minimum donation per pane is \$100.

Brea Civic & Cultural Center
Facility Rental

- *Seminars*
- *Meetings*
- *Banquets*
- *Receptions*
- *Reasonable Rates*
- *Free Parking*
- *Prime Location*
- *Unique Facilities*

BREA CIVIC & CULTURAL CENTER

(714) 990-7643

One Civic Center Circle, Brea, CA 92621
(Corner of Birch & Randolph, near Brea Mall)



**Watch for Brea's new
Community Center opening in 1996.**
(See reverse for more information.)

Brea Civic & Cultural Center
Facility Rental

(714) 990-7643

Opening 1996

BREA COMMUNITY CENTER

- *Grand Community Hall*
- *Garden and Patio Areas*
- *Meeting and Conference Rooms*
- *Tiny Tots Area and Playground*
- *Arts Studio*
- *Gymnasium, and more*

Call Today!

**BREA'S CIVIC
AND CULTURAL CENTER**

- *Training Auditorium*
- *Performing Arts Theatre*
- *Banquet and Meeting Rooms*
- *Brea Art Gallery/Museum*



BREA

DAILY STAR-

55TH YEAR—NO. 178

TELEPHONE (213) 697-1734 or (714) 529-2144

MONDAY

Brea Planners Will Discuss Name Changes

BREA—Five public hearings will be before the planning commission tonight with two street name changes and consideration of location for the proposed community center topping the list.

Opposition to changing the name of Birch Street to Brea-Olinda Road is expected to be heard from the Brea-Olinda Unified School District in a statement from the board of trustees which was approved Wednesday night.

The board went on record as opposing the name change which would affect the area which is now Birch Street in front of the high school. According to the board the name change is not warranted and the street should remain Birch within the city limits of Brea.

Also before the commission will be a recommendation from the Brea City Council to consider an area bounded by Imperial Highway, Poplar Ave-

nue, Birch Street and Randolph Avenue as the future site of the proposed community center.

A complete agenda of tonight's meeting follows:
Meeting called to order (6:00 P.M.)

- Roll call
- Work session
- General session (7:30 P.M.)
- Pledge of allegiance
- Approval of minutes of regular meeting of Dec. 1.
- Correspondence
- Public hearings:

Street name change - Birch Street to Brea-Olinda Road: A public hearing on a request from the city council for the planning commission to initiate action to change the street name of Birch Street between Sievers Avenue and Valencia Avenue to Brea Olinda Road.

Street name change - Central Avenue to State College Boulevard: A public hearing on a request by the planning commission to initiate action to change the street name of Central Avenue between Brea Boulevard and Lambert Road to State College Boulevard.

Street name change - Cherry Street to Flower Street: A public hearing on a request from area residents for the planning commission to initiate action to change the name of Flower Avenue between Locust Street



GETTING SETTLED — Russell Brooks, new manager of the Brea Chamber of Commerce, completed his first day on the job today and will play host Tuesday to chamber

members throughout the get-acquainted party. Till chamber office manager Brooks as he begins his first the job.

(Daily Star-Progressive)

Russell Brooks Takes Over Brea Chamber Post Today

Israel Adds 'Hawk' To Its Cabinet

Russell Brooks, Ken Fisher who accepted a similar position with the Anaheim Chamber of Commerce from 9 a.m. to 4 p.m. today.

WHAT'S UP AT THE COMMUNITY CENTER...

IT'S COMING IN 1996!

Check it out! Coming in 1996, the City of Brea Community Center is designed to become a focal point for Brea; a place where all are invited to come together to play, learn, socialize, create, seek help, relax and celebrate. The Community Center will be a place to meet the community's ever growing and changing needs for cultural and recreational activities and human services.

This beautiful, state of the art facility will be open and accessible to all ages and interests. Throughout the year the Center will be open from 6 a.m. - 10 p.m. Monday through Friday, from 10 a.m. - 8 p.m. on Saturday and 10 a.m. - 5 p.m. on Sundays. Additionally, the Center will be open for special events and can be rented for weddings, banquets, receptions, etc.

Programs and Facilities

Active Recreation (Sports) Facilities - 11,236 square feet



The gymnasium will accommodate a variety of sports activities including basketball, volleyball, indoor hockey, soccer, dances, contests, special theme parties. The Fitness Area will feature strength training and cardiovascular fitness, instruction programs and exercise and dance classes for all ages.

- ◆ Gymnasium
- ◆ Volleyball courts
- ◆ Aerobic exercise and dance studio featuring a cushioned hardwood floor
- ◆ Full court basketball with spectator seating for 300+
- ◆ Fitness and weight training center
- ◆ Men's and women's shower & locker facilities

Community Center Cafe`

A great place to gather with friends. Delicious assortment of health conscious foods and beverages are served.

Family and Youth Facilities



A very strong commitment to youth and families is evident at the Community Center. A free, supervised afterschool program will be offered at the Center every weekday. Kids can come with their friends and play games, get help with homework and make craft projects. Also there will be a range of professional services and activities to support and assist families and youth.

- ◆ Tiny tots program
- ◆ Baby sitting services
- ◆ Teen lounge
- ◆ Childrens' learning playground
- ◆ Youth and family services

Special Use and Community Rental Facilities



A variety of rooms have been designed to accommodate a wide range of activities from Community events to classes ranging from arts and crafts to karate and computer seminars and rental by businesses and individuals. Rooms open onto an outdoor patio.

- ◆ Grand Community Hall with outdoor patio
 - banquet seating for 390
 - auditorium style seating for 600
- ◆ Meeting rooms
 - classroom seating for 30, auditorium seating for 50
- ◆ Art studio, classroom style seating for 32
- ◆ Art garden
- ◆ Catering kitchen

For more information about the Community Center, call 990-7771

8-8-96



Susan Gaede/For the Brea Progress
Brea Historical Society members June O'Brien (left) and Sharon Dean greet
visitors at the Brea Community Center grand opening July 27.